

Waterhouse Business Centre

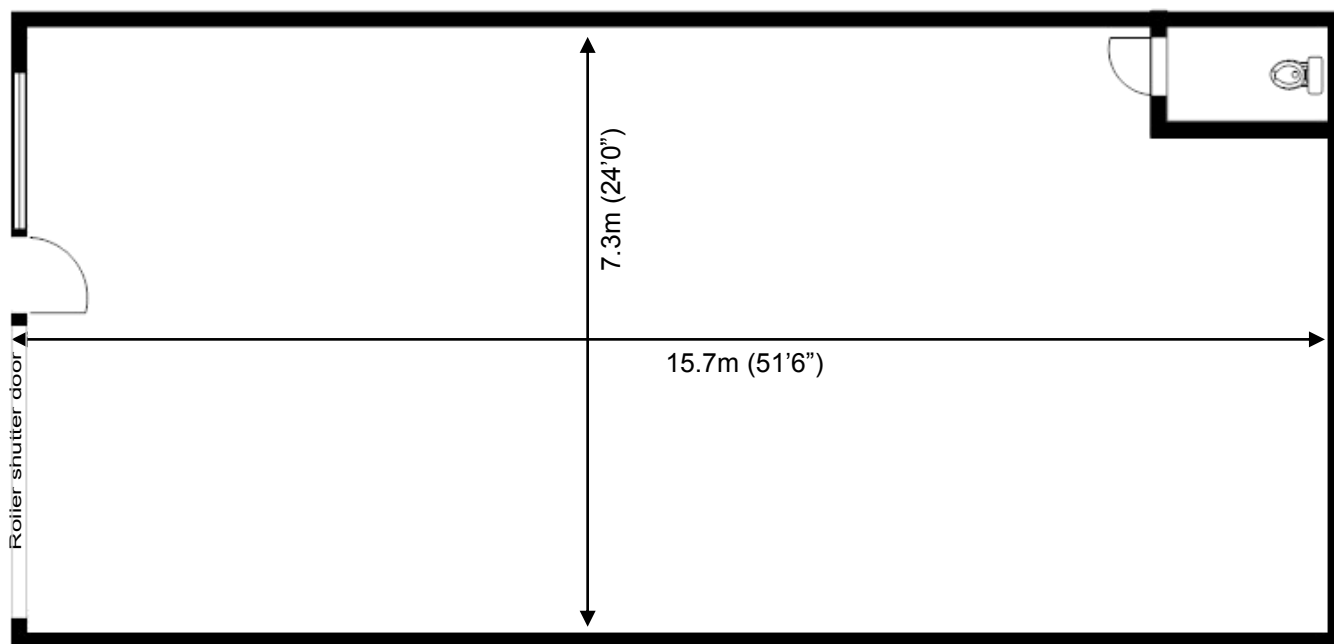

Unit 36

113.3 sq m (1220 sq ft)*



Waterhouse Business Centre

Cromar Way
Chelmsford
Essex CM1 2QE

01245 392000

*Approximate Measurements

Not to scale

Space for growing businesses

www.capitalspace.co.uk

Waterhouse Business Centre



Unit 36

113.3 sq m (1220 sq ft)*

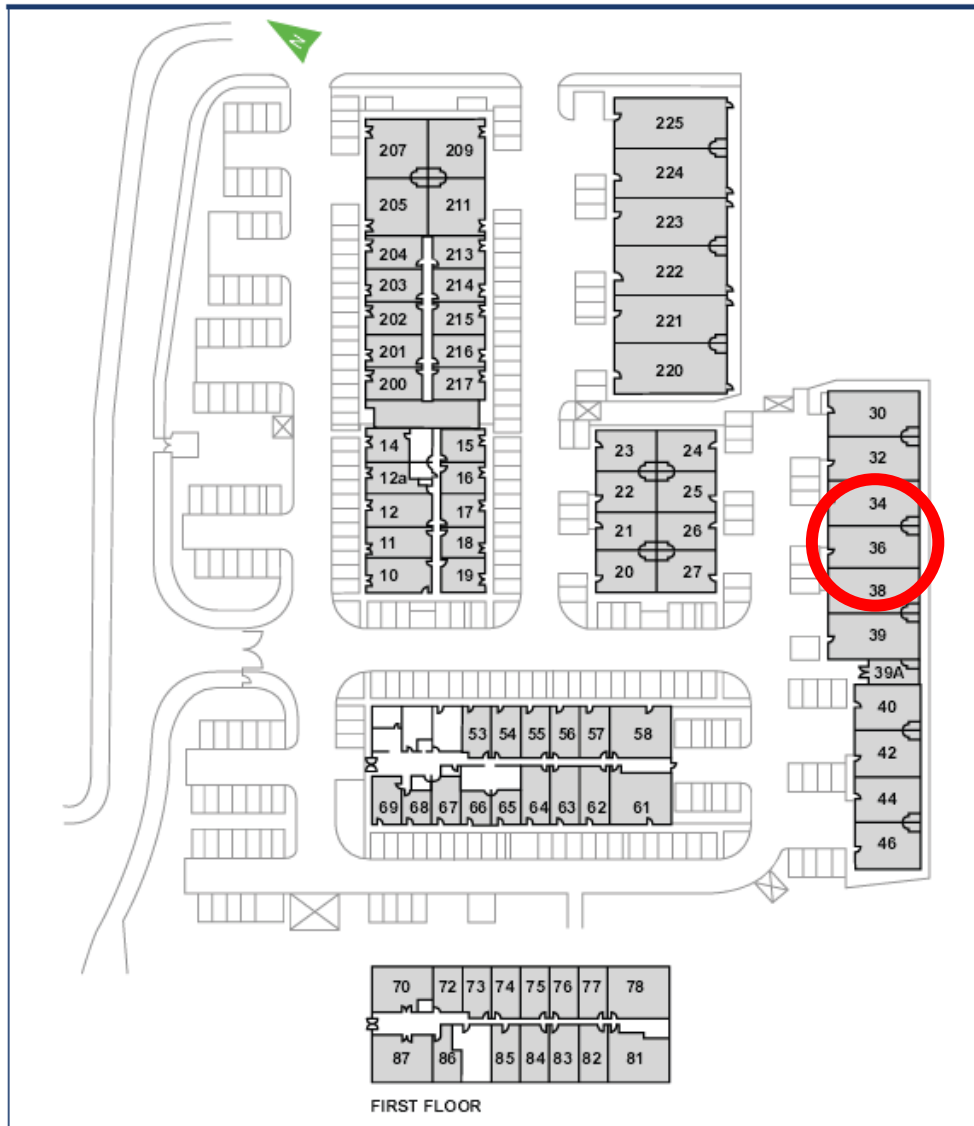

Additional Information

Has 9 additional double plug sockets and CAT5 outlets around the workshop

We are happy to provide further details and answer any questions. Please contact our Centre Manager on 01245 392000.

Waterhouse Business Centre

Cromar Way
Chelmsford
Essex CM1 2QE

01245 392000

*Approximate Measurements

Not to scale

Space for growing businesses

www.capitalspace.co.uk