

# Waterhouse Business Centre

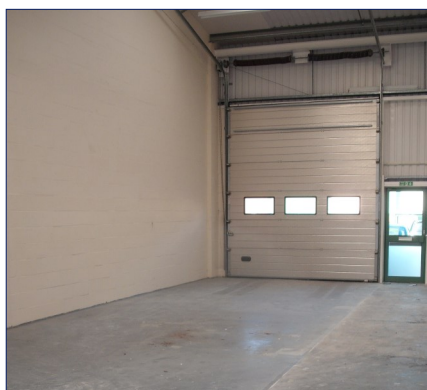

Unit 44

83.6 sq m (900 sq ft)\*

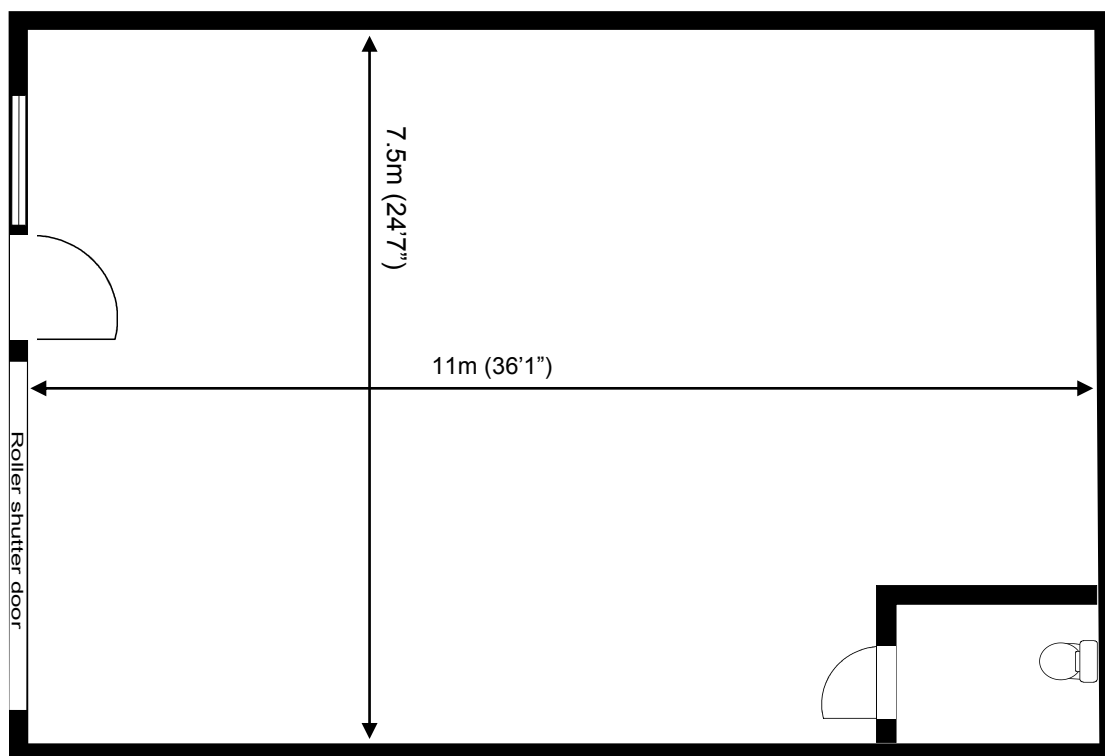

## Waterhouse Business Centre

Cromar Way  
Chelmsford  
Essex CM1 2QE  
01245 392000

\*Approximate Measurements

Not to scale

Space for growing businesses

[www.capitalspace.co.uk](http://www.capitalspace.co.uk)

# Waterhouse Business Centre



Unit 44

83.6 sq m (900 sq ft)\*

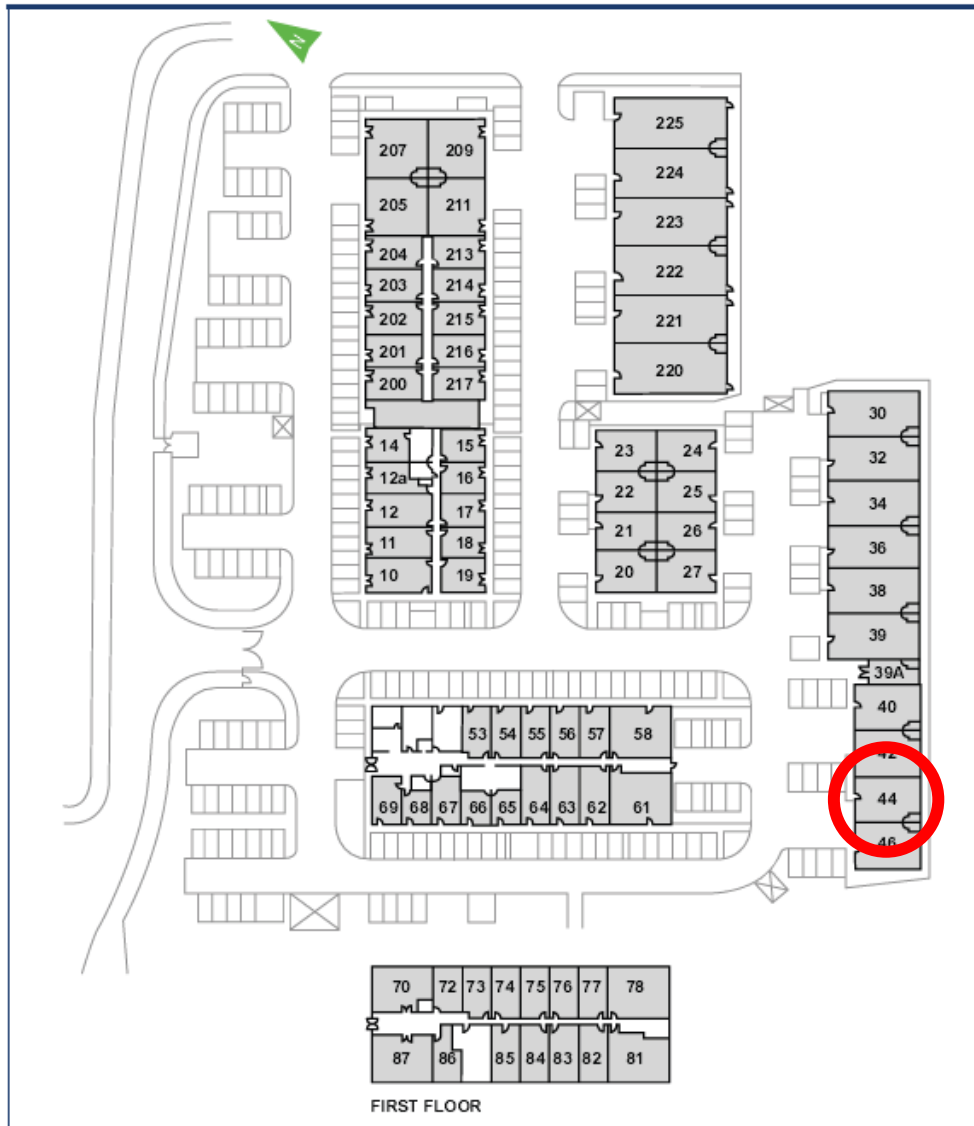

## Additional Information

Has 9 additional double plug sockets and CAT5 outlets around the workshop

We are happy to provide further details and answer any questions. Please contact our Centre Manager on 01245 392000.

### Waterhouse Business Centre

Cromar Way  
Chelmsford  
Essex CM1 2QE

01245 392000

\*Approximate Measurements

Not to scale

Space for growing businesses

[www.capitalspace.co.uk](http://www.capitalspace.co.uk)