

Waterhouse Business Centre

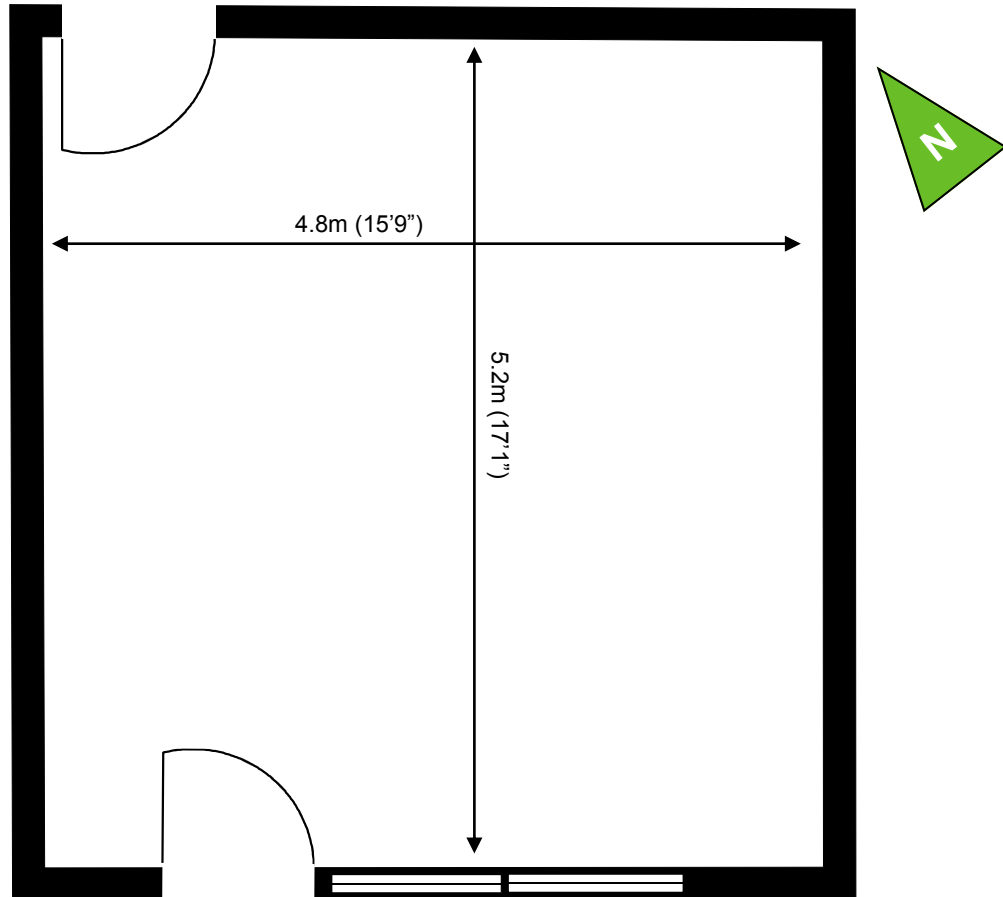

Ground Floor - Unit 65

24.8 sq m (267 sq ft)*



Waterhouse Business Centre

Cromar Way
Chelmsford
Essex CM1 2QE
01245 392000

*Approximate Measurements

Not to scale

Space for growing businesses

www.capitalspace.co.uk

Waterhouse Business Centre



Ground Floor - Unit 65

24.8 sq m (267 sq ft)*



Additional Information

We are happy to provide further details and answer any questions.
Please contact our Centre Manager on 01245 392000.

Waterhouse Business Centre

Cromar Way
Chelmsford
Essex CM1 2QE
01245 392000

*Approximate Measurements

Not to scale

Space for growing businesses

www.capitalspace.co.uk