

# Capital Business Centre

Ground Floor—Unit 35

70 m (753 sq ft)\*

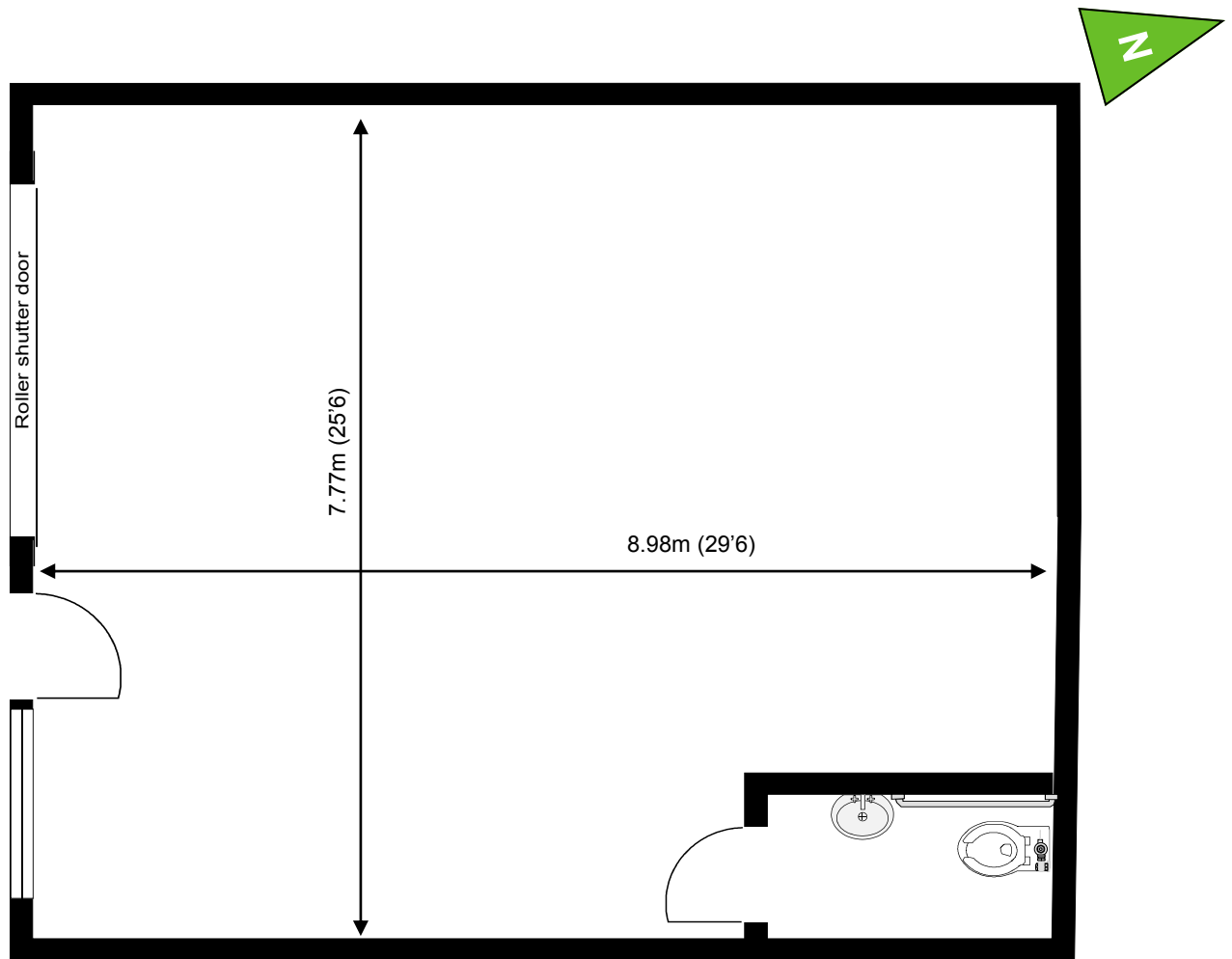

## Capital Business Centre

22 Carlton Road  
South Croydon  
Surrey CR2 0BS

\*Approximate Measurements

Not to scale

Space for growing businesses

[www.capitalspace.co.uk](http://www.capitalspace.co.uk)

# Capital Business Centre

Ground Floor—Unit 35  
70 m (753 sq ft)\*

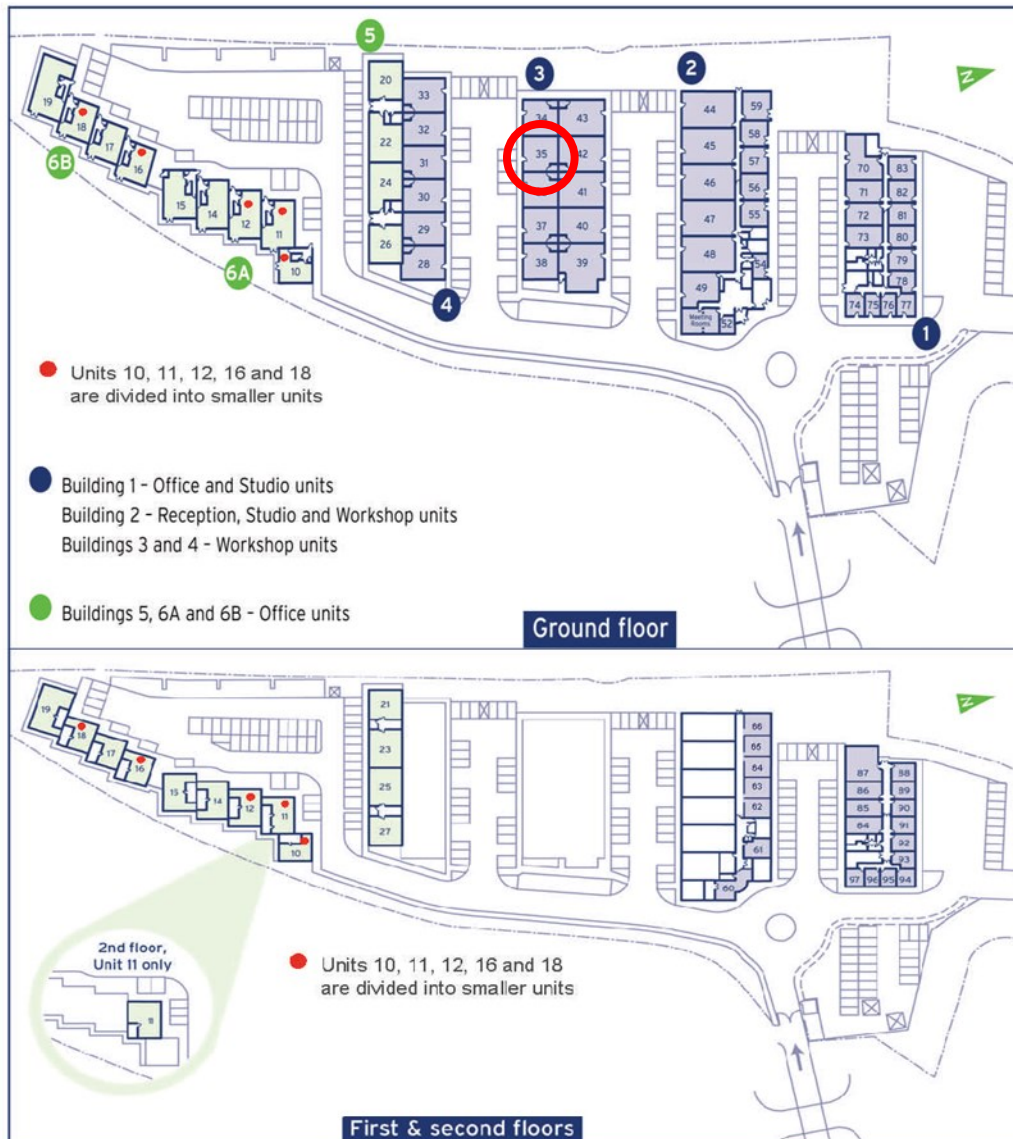

## Additional Information

Own entrance, own toilet. Roller shutter door.

We are happy to provide further details and answer any questions.  
Please contact our Centre Manager on 020 8916 2000.

**Capital Business Centre**  
22 Carlton Road  
South Croydon  
Surrey CR2 0BS

\*Approximate Measurements

Not to scale

Space for growing businesses

[www.capitalspace.co.uk](http://www.capitalspace.co.uk)